



"TUSCAN"



"FLORIDA MODERN"

"The Caribe Plan"

386.313.6221

[www.GoldCoastCustomHomes.com](http://www.GoldCoastCustomHomes.com)

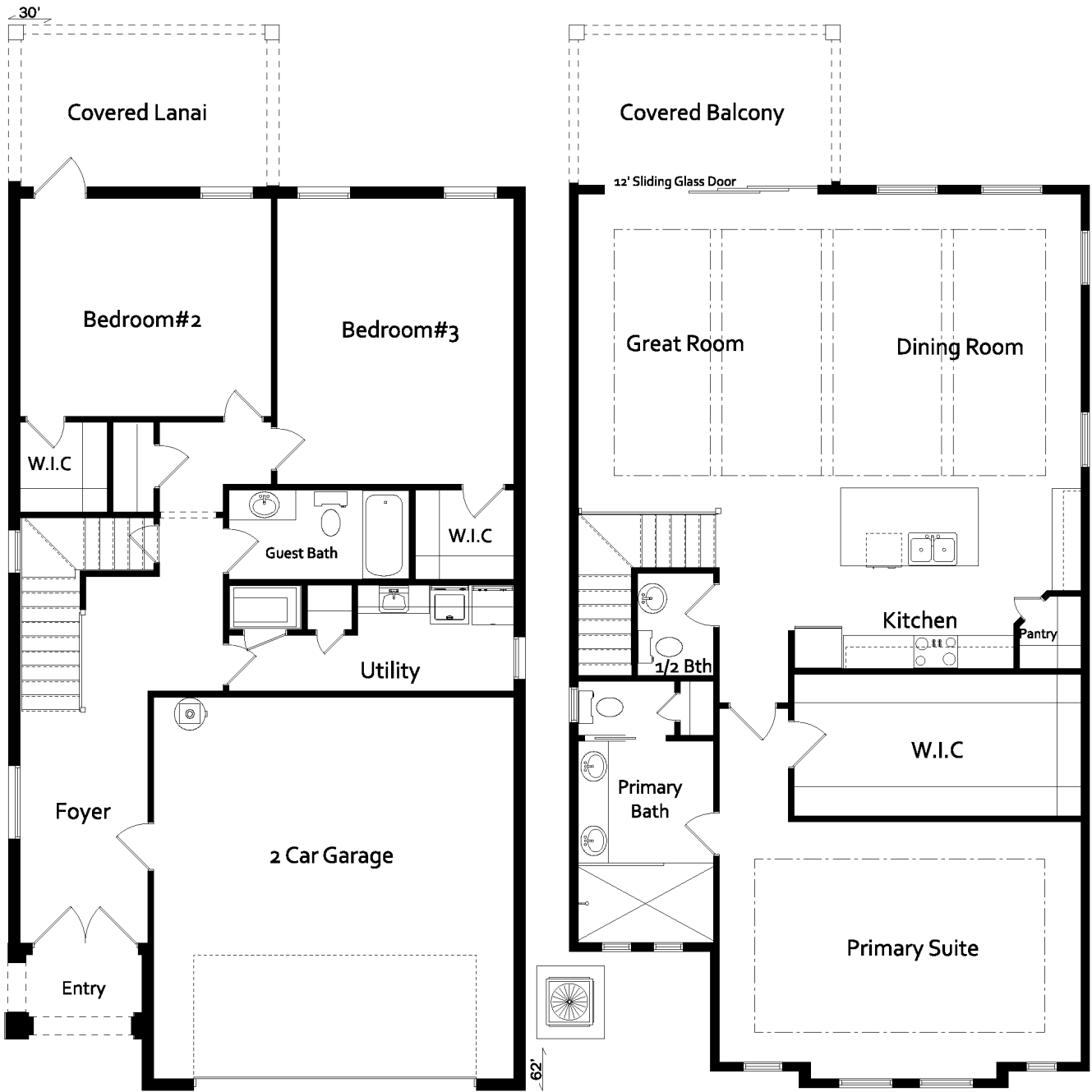

### Measurements

Great Room .....	18' X 16'8"	Primary Suite.....	20' X 13'
Dining Room .....	12' X 16'8"	Primary W.I.C.....	12' X 7'6"
Foyer .....	7'4" X 13'	Bedroom#2.....	14' X 12'
Covered Lanai.....	15' X 9'	Bedroom#3 .....	16' X 13'
Covered Balcony.....	15' X 9'	2 Car Garage .....	20' X 22'

Living Sqft.....	2310
Entry.....	35
Garage.....	485
Covered Lanai.....	300
<b>Total Sqft.....</b>	<b>3130</b>



# "The Caribe I"

Ceiling Heights  
- 10'+ Ceilings Throughout Entire Home